



FIT PLUS MONITOR ARM

DYNAMIC HEAVY WEIGHT SOLUTION

Space saving dynamic and durable

With the FIT PLUS Monitor Arm, enjoy a dual monitor set-up with effortless flexibility. An incredibly functional desk top solution, it features an impressive weight capacity; able to comfortably hold two 24-inch monitors.

To ensure you are working in the correct ergonomic position, you can easily rotate, swivel or tilt each screen to the desired angle or height and go from focused individual work to collaboration by sharing your screen in an instant.



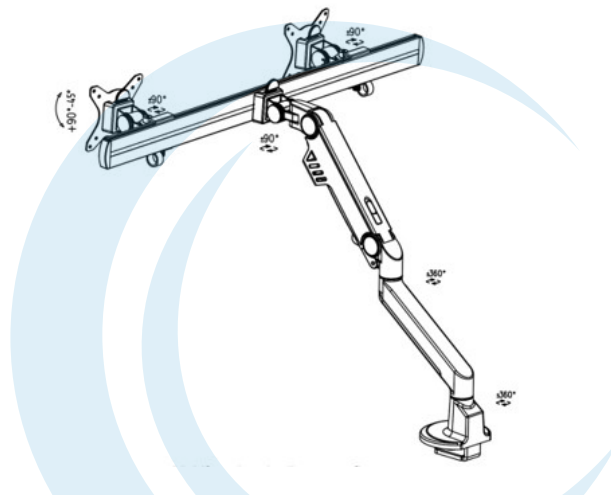
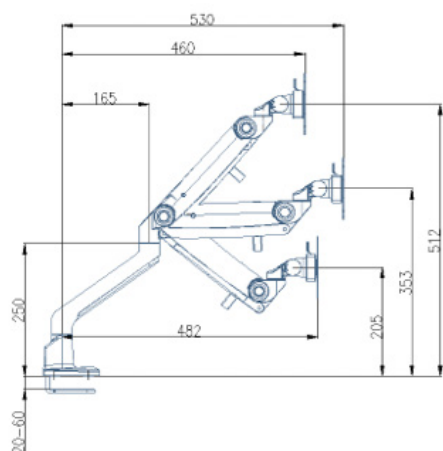

FIT PLUS MONITOR ARM

SPECIFICATIONS

Fit plus rocust and effective

FEATURES AND BENEFITS

- ✓ Instant nger touch adjustment, no need for tools
- ✓ Modern design to maximise desk space and neatly manage cables
- ✓ Functional single and dual monitor options
- ✓ Space-saving design accommodates dual screens from one arm
- ✓ VESA-compliant, supporting 95% of today's monitors (up to 10 kgs)
- ✓ Instant portrait to landscape adjustability
- ✓ Quick-release VESA mount
- ✓ Green star compliant
- ✓ Interchangeable mounting options for a huge range of monitors and devices
- ✓ Compact design with internal cable management cover and clips
- ✓ Quick and easy installation

Forward extension range	53 cm (12–54 cm from base)
Verticl Range	30 cm (18–48 cm from desktop)
Quick-release VESA mount	75 cm x 75 cm to 100 cm x 100 cm compatible
Portrait to landscape adjustment	Instant
Top mount desk clamp	Suitable for desks between 20 mm to 60 mm in thickness
Grommet fixing	Suitable for 7 mm to 80 mm top thickness
Warranty Tested	5-year extendable warranty Up to 100,000 cycles
Maximum load weight	Up to 10 kg (two standard 24 inch monitors).
Cable management	Neatly tidied with clips and sliding covers.
Colours	Black, White, Silver